

SPULEN- SORTIMENT

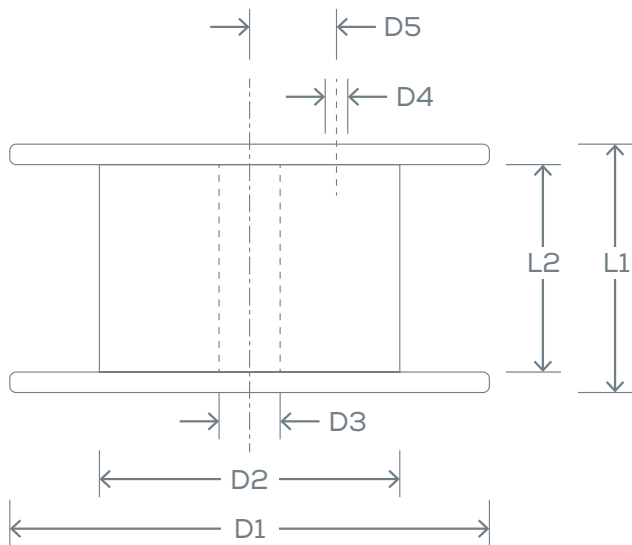

Typ	Material	D1 (in mm)	D2 (in mm)	D3 (in mm)	D4 (in mm)	D5 (in mm)	L1 (in mm)	L2 (in mm)	Leer- gewicht	Füll- gewicht
K250	Kunststoff	250	160	22	13	43	200	160	ca. 1,5 kg	ca. 20 kg
K355	Kunststoff	355	225	35	26	80	200	160	ca. 3,5 kg	ca. 40 kg
K500	Kunststoff	500	320	35	26	80	250	180	ca. 8 kg	ca. 100 kg
VM710	Kunststoff	710	500	55	26	140	250	180	ca. 15 kg	ca. 200 kg
VM800	Kunststoff	800	400	85	26	140	320	250	ca. 20 kg	ca. 400 kg
H1150	Holz	1150	630	80	22	80	340	280	ca. 52 kg	ca. 1000 kg
ND630	Stahl	630	355	127	28	140	445	405	ca. 64 kg	ca. 350 kg
EGE762	Stahl	762	355	127	28	140	550	500	ca. 107 kg	ca. 950 kg

Zylindrische Spulen nach IEC 60264-2, DIN 46399, 46395 sowie andere kundenindividuelle Spezifikationen sind auf Anfrage möglich.

ASSORTMENT OF SPOOLS

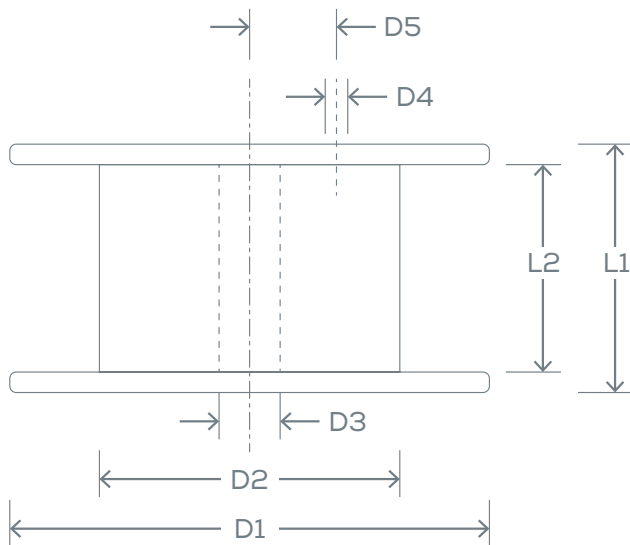

Type	Material	D1 (in mm)	D2 (in mm)	D3 (in mm)	D4 (in mm)	D5 (in mm)	L1 (in mm)	L2 (in mm)	Deadweight	Weight
K250	Plastic	250	160	22	13	43	200	160	Approx. 1.5 kg	Approx. 20 kg
K355	Plastic	355	225	35	26	80	200	160	Approx. 3.5 kg	Approx. 40 kg
K500	Plastic	500	320	35	26	80	250	180	Approx. 8 kg	Approx. 100 kg
VM710	Plastic	710	500	55	26	140	250	180	Approx.. 15 kg	Approx. 200 kg
VM800	Plastic	800	400	85	26	140	320	250	Approx. 20 kg	Approx. 400 kg
H1150	Wood	1,150	630	80	22	80	340	280	Approx. 52 kg	Approx. 1,000 kg
ND630	Steel	630	355	127	28	140	445	405	Approx. 64 kg	Approx. 350 kg
EGE762	Steel	762	355	127	28	140	550	500	Approx. 107 kg	Approx. 950 kg

Cylindrical barrelled delivery spools acc. to IEC 60264-2, DIN 46399 or 46395 and other customised specifications are possible upon request.